

- NOTES**
1. ALL DIMENSIONS IN METRES AND ALL LEVELS IN METRES UNLESS SHOWN OTHERWISE.
 2. TOPOGRAPHICAL SURVEY COMPLETED BY MALCOLM HUGHES LAND SURVEYORS DATED JULY/AUGUST 2021.
 3. STRUCTURAL COMPONENTS ARE SHOWN INDICATIVE.
 4. EARTHWORK SLOPES ASSUMED TO BE 1:2, ROCK CUTTING SLOPES ASSUMED TO BE 70 DEGREES ASSUMING COMPETENT SHALLOW ROAD, THE SLOPES WOULD REQUIRE STABILISATION AND SLOPE STABILITY ANALYSIS TO BE CARRIED OUT TO CONFIRM.
 5. TRAFFIC MANAGEMENT ARRANGEMENTS TO BE CONFIRMED WITH TRANSPORT SCOTLAND.
 6. NETWORK RAIL TO BE CONSULTED REGARDING THE PROXIMITY OF THE WORKS TO THE EXISTING MASONRY WALL.

LEGEND

- LOCK AWE WATER LEVEL
- PROPOSED BYPASS ROAD
- PROPOSED VERGE

REFERENCE

SCALE 1:250

m 5 0 25m

CURRENT VERSION INFORMATION

B. LIST OF CURRENT VERSION

THIS DRAWING IS ISSUED BY STANTEC UK SUBJECT TO THE CONDITIONS THAT IT IS NOT TO BE REPRODUCED IN WHOLE OR IN PART OR RECLOSED TO THIRD PARTIES WITHOUT THE WRITTEN AUTHORIZATION OF STANTEC UK. PREVIOUS VERSIONS OF THIS DRAWING SHOULD BE STAMPED, SUSPENDED OR DESTROYED. DO NOT SCALE THIS DRAWING IF IN DOUBT ASK.

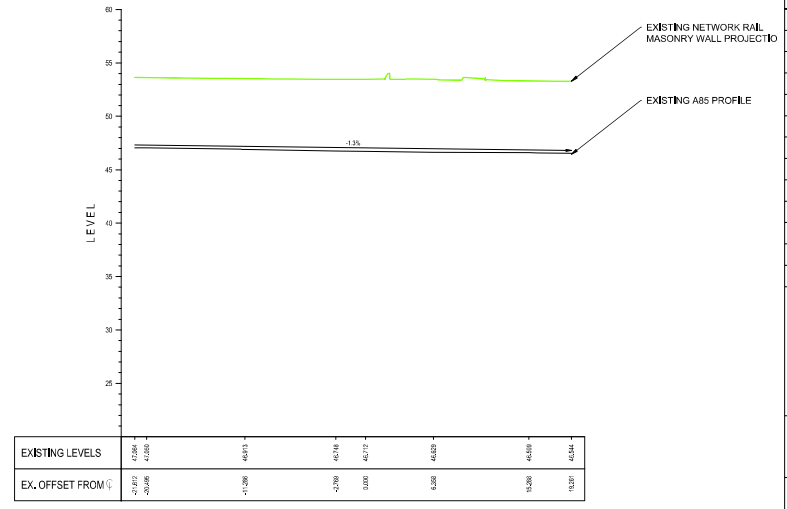
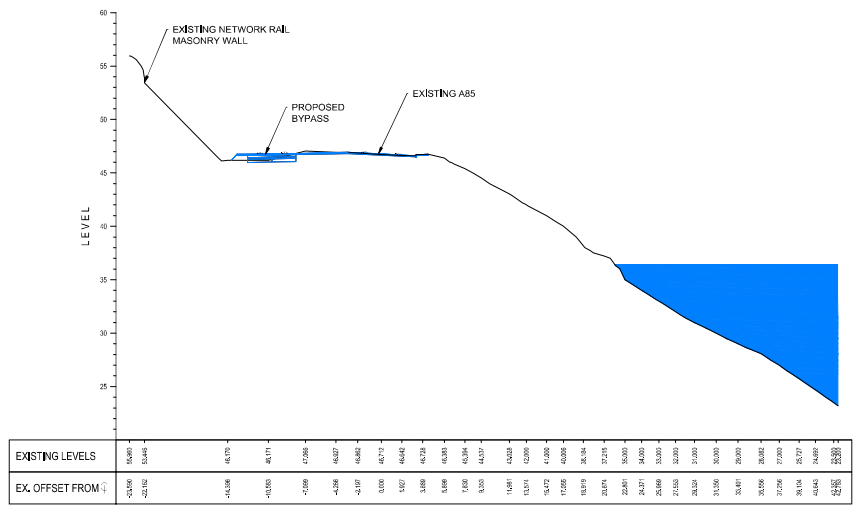

SECTION SL-01

SECTION SL-02

Figure No: 3.5

06.10.21	ET	BR	MP	F01	DRAFT	
DATE	DRAWN	CHECK	REVIS	VER	REASON FOR ISSUE	
DRAX CRUACHAN EXPANSION LTD. CRUACHAN 2 A85 DIVERSIONARY OPTION 2 CONCEPT SKETCHES STAGE 2 - BYPASS CONSTRUCTED						
CONTRACT NO.	001	SCALE	1:250	MASTER FILE	A1	
DRAWING NO.	331201086/001/C/0862				VERSION	P01